



INSTALLATION INSTRUCTIONS

Accessory
SPARE TIRE KIT
 P/N: 06421-TV9-A02 (17")
 P/N: 06421-TV9-A12 (18")

Application
 2017 ILX

Publications No.
VERSION 1
 Issue Date
SEP 2016

PARTS LIST

Spare tire rim

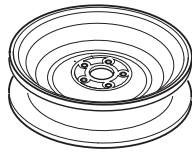

Valve stem

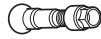

Spare tire caution label



Hold down bolt



Tool case

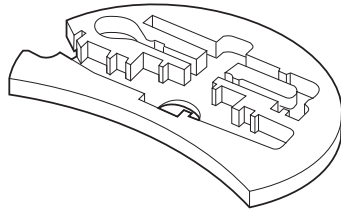

Jack

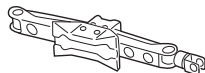

Wheel nut wrench/Jack handle

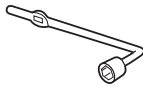

Extension bar



Tire and load information label



Spare tire cover

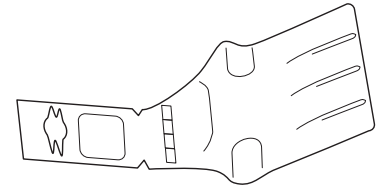

Spare tire (T135/70D17)
(sold separately)

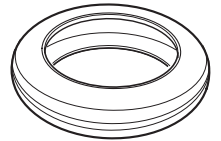

TOOLS AND SUPPLIES REQUIRED

Isopropyl alcohol

Shop towel

Trim clip remover

INSTALLATION

Client Information: The information in this installation instruction is intended for use only by skilled technicians who have the proper tools, equipment, and training to correctly and safely add equipment to your vehicle. These procedures should not be attempted by "do-it-yourselfers."

NOTE:

- Be careful not to scratch the interior trim when installing the spare tire kit.
 - Install the correct size tire.
 - Use a tire changer, and the Operation Manual furnished with the tire changer to install the spare tire on the spare tire rim.
 - Give all the removed parts to your client.
1. Using isopropyl alcohol on a shop towel, clean the spare tire rim in the area shown.

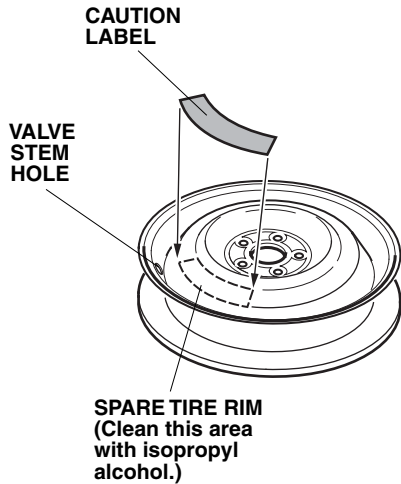

2. Remove the adhesive backing from the caution label, and attach the caution label to the spare tire rim in the area shown.
3. Use a tire changer to install the spare tire (sold separately) onto the spare tire rim. Inflate the spare tire to 60 psi (4.2 kgf/cm²).

Installing the Spare Tire Kit

4. With the trunk open, remove the trunk floor cover.

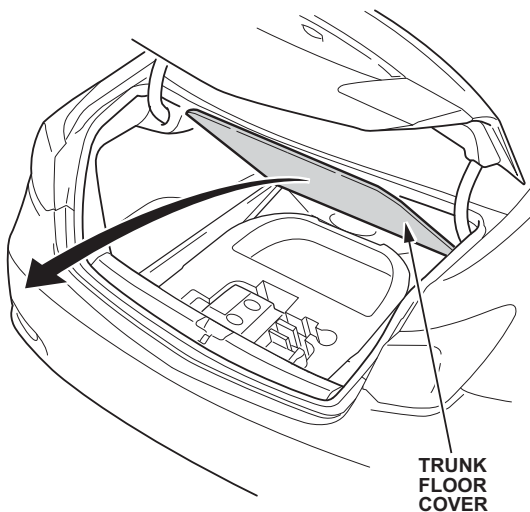

5. Remove the old tool box, and set it aside, it will not be reused.

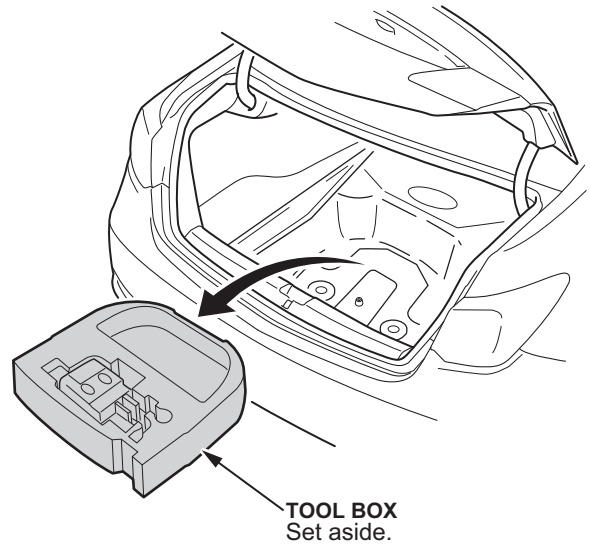

6. Install the jack, the wheel nut wrench/jack handle, and the extension bar into the new tool box.

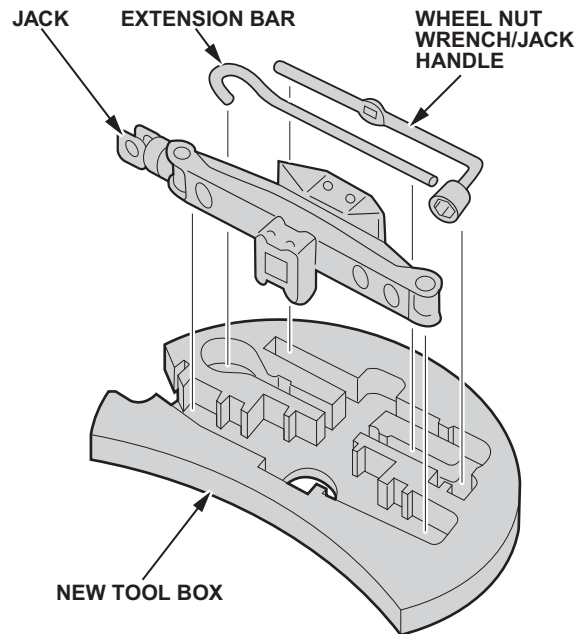

7. Using isopropyl alcohol on a shop towel, clean the spare tire well in the area shown.

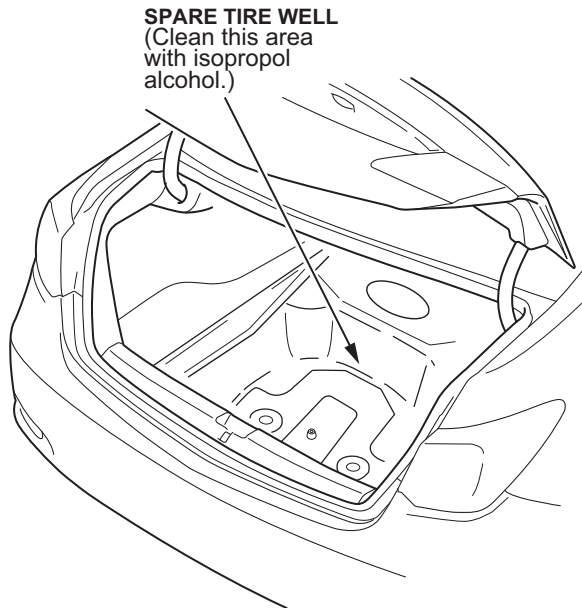

8. Remove the adhesive backing, and install the spare tire cover with the arrow pointing to the front of the vehicle.

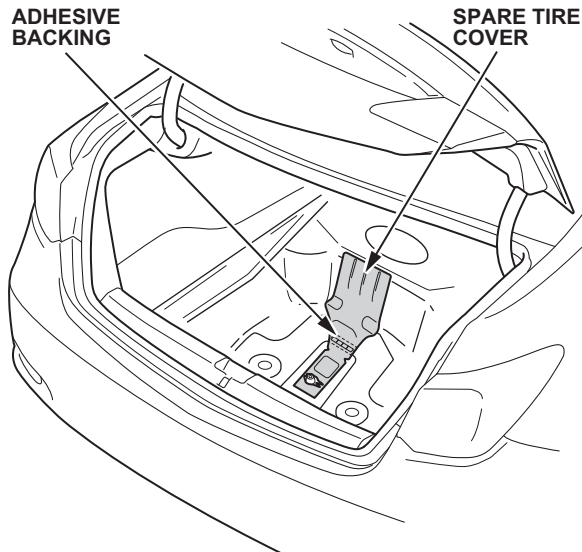

9. Install the spare tire assembly into the spare tire area (label side down), and secure it to the vehicle using the spare tire hold down bolt provided. Tighten the bolt securely.

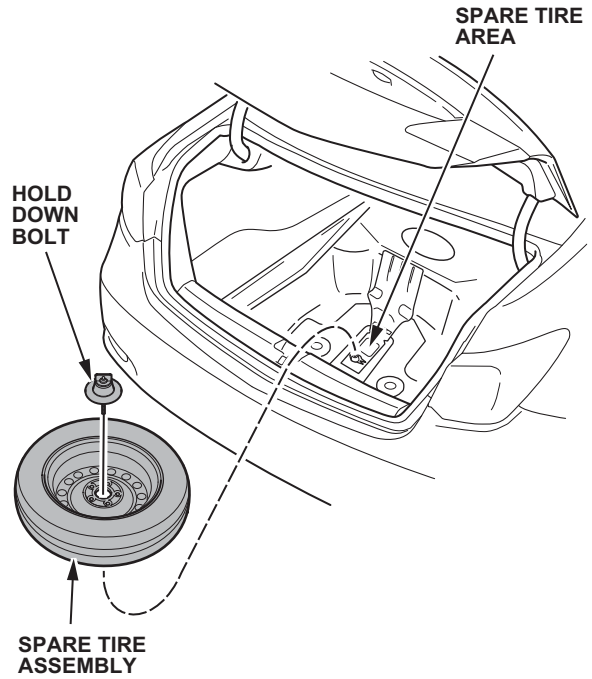

10. Install the new tool box into the trunk area over the spare tire in the direction shown. Then install the trunk floor cover.

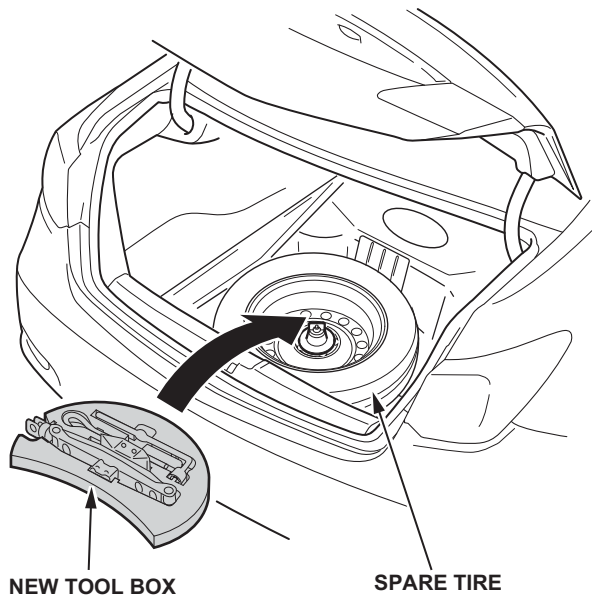

11. Open the driver's door and locate the "TIRE AND LOADING INFORMATION" label on the doorjamb. Using isopropyl alcohol on a shop towel, clean the doorjamb over the existing label.

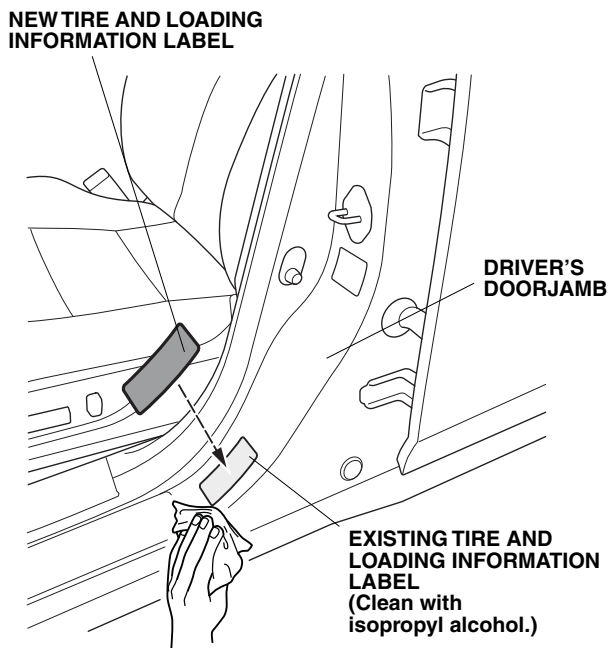

12. Remove the adhesive backing from the new "TIRE AND LOADING INFORMATION" label, and attach it over the existing label.
13. Return all of the removed parts to the client.